

Aim to be the global leader in head protection solutions!

INSTRUCTION FOR USE

J&Y SAFETY

HEARING PROTECTION
PRODUCTS



Main Plant Guangdong J&Y Industrial Co., Ltd.

COMPANY PROFILE

(General Plant) of the production base.Guangzhou J&Y Safety product manufacturing Co., Ltd. (Main plant) established in 2008.The two factories are only 20 minutes away from Guangzhou New Baiyun Airport, adjacent to Huadu port, with superior geographical location. Our company is an integrated enterprise of R & D, production and sales of head protective equipment, covering an area of 30000 Sq meter in the total plant, 20000 Sq meter in the branch plant, 10 million in the total registered capital, 8.99 million in the branch plant, more than 400 production line employees and management personnel, 60 management personnel and 20 engineering R & D personnel. We has successively obtained more than 118 patents and "high tech enterprise certificate". The main products are Pu earplug, silicone earplugs, earmuffs, safety goggles, electronic earmuffs, communication earmuffs, protective masks, medical masks, medical goggles, safety helmets, etc. The products are mainly used for personal protection, including factories, mines, military, aviation, tourism, sports, medical and daily use.

The company adheres to the business philosophy of "being the most professional head protection manufacturer in China", pays attention to talents, strict management and product passing; ISO90001 / 13485, European CE certification, American ANSI certification and Australian as / NZS certification.

The company has independent import and export rights, 80% of the products are sold to the United States, Europe, Australia, Japan, Hong Kong and Taiwan, etc., the company is recognized by new and old customers with high-quality product performance, affordable price and good after-sales service.

The company has been committed to; the pursuit of excellent quality, sincere service to customers! Has been committed to the head of security products in the field of excellence! Has been committed to creating value for customers!

2008
FOUNDED

750+
EMPLOYEE

OEM & ODM
SERVICE

30.000M²
FACTORY AREA

56.000M²
WORKSHOP AREA



Branch Plant J&Y SAFETY (M) SDN.BHD.

COMPANY PROFILE

J&Y SAFETY (M) SDN.BHD. is located in Shah Alam,Selangor, KL, covering an area of 2,000 squaremeters and a construction area of more than 4,000 squaremeters. There are more than 30 production front-line employees and management personnel, and a total of 10 engineering R&D personnel teams.

Main products: PU earplugs, silicone earplugs, protective earmuffs, electronic earmuffs, communication earmuffs, and safety helmets, etc.

2024
FOUNDED

40+
EMPLOYEE

OEM & ODM
SERVICE

2.000M²
COVERING AN AREA

4.000M²
CONSTRUCTION AREA

Hearing Protection by J&Y

All earplugs we produced are with premium quality, raw material original from Germany.
They are tested by the authoritative Laboratory of NVLAP certification in US.

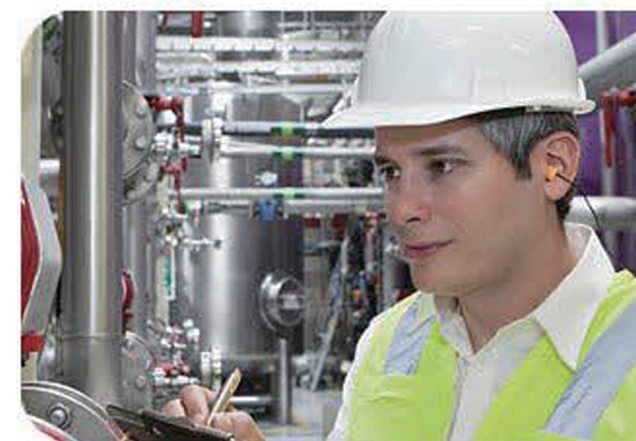
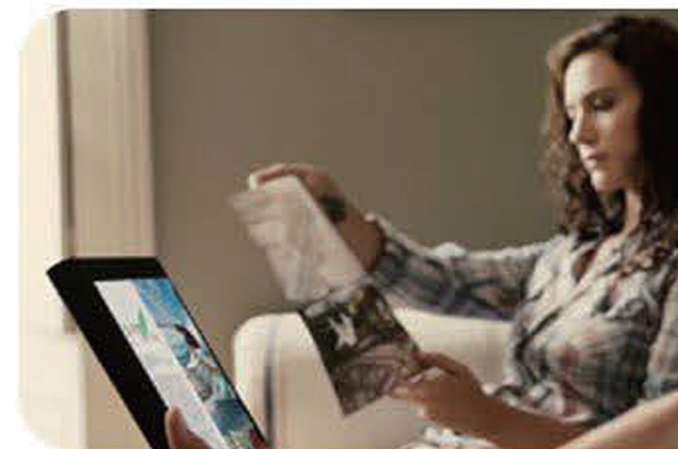
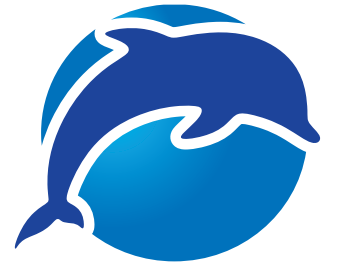

Instruction for Hard Hat Attached Earmuffs

This model of earmuff is to be worn with a hard hat. When worn correctly, the earmuff is fixed into the hard hat's side accessory slots. The earmuffs should be fitted to and used only with MSA V-gard.

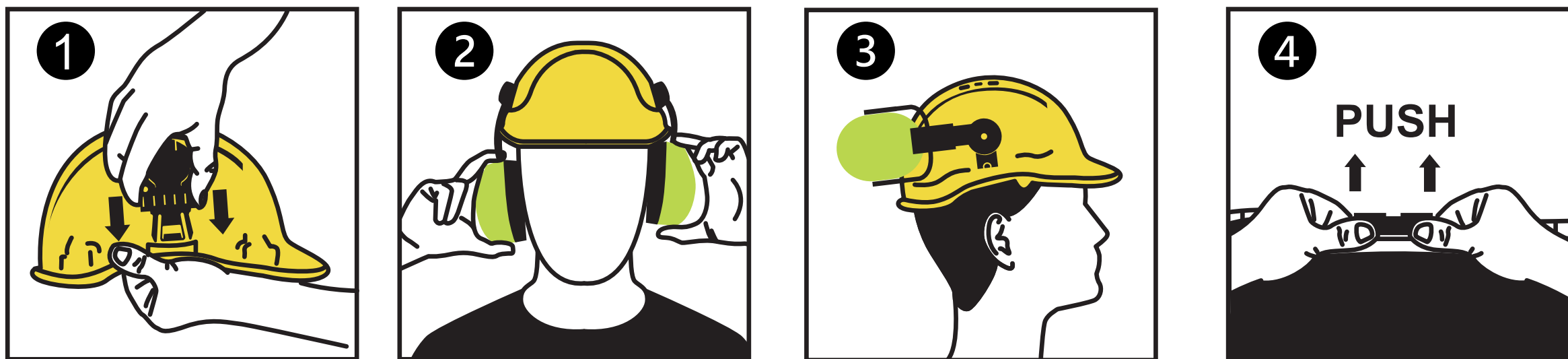

1. Push the earmuff adapter firmly into the hard hat's side accessory slots.
2. Put the hard hat on and push the earmuffs inwards to engage their active position covering your ears. Adjust the earmuff up and down for a personalized fit.
3. When not wearing the earmuffs, pull the earmuffs away from the ears, turn 90 degrees and place them in the rest position.
4. Push the slots sticking point of the adapter outwardly with more force until it can unload successfully.

Instruction for Over-The-Head Earmuffs

This model of earmuff is to be worn over the head. when worn correctly, the headband of the earmuff is to rest on top of your head.

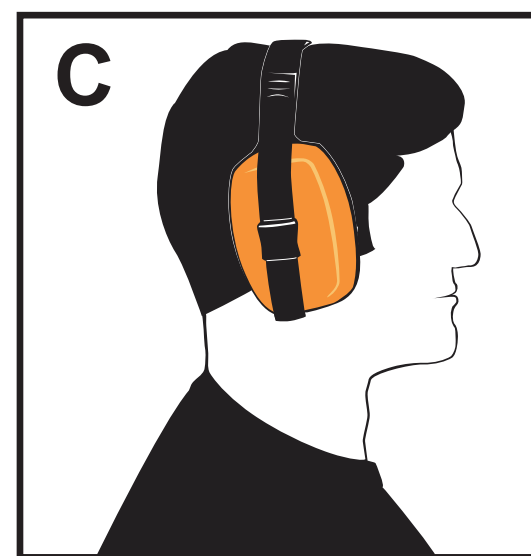
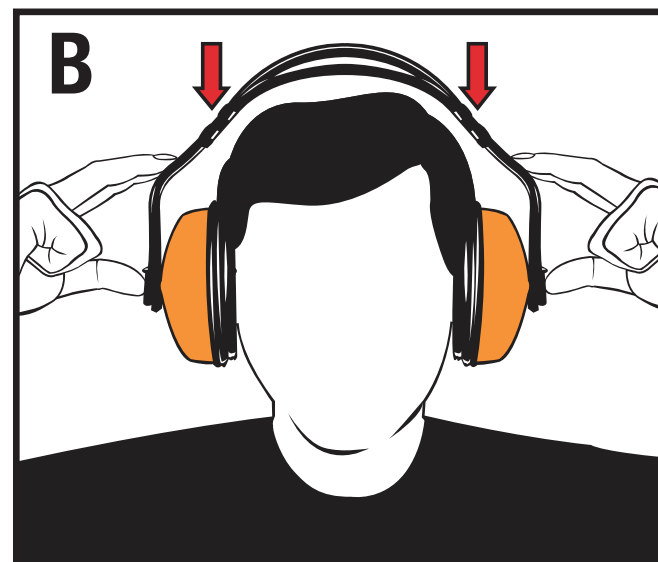

- A. Pull the cups outward and place over your ears so that the cushions fully enclose the ears and seal tightly against the head.
- B. Adjust the height of each cup on both sides while holding the headband down until you have a tight and comfortable fit.
- C. The headband should sit straight on the head.

Instruction for Behind-The-Head Earmuffs

Before wearing, please check that the product is intact and carefully read the illustrations. Part your hair on both sides of your ears and remove any items that may affect the acoustic seal, such as earrings. Then, follow the steps below to wear it properly.

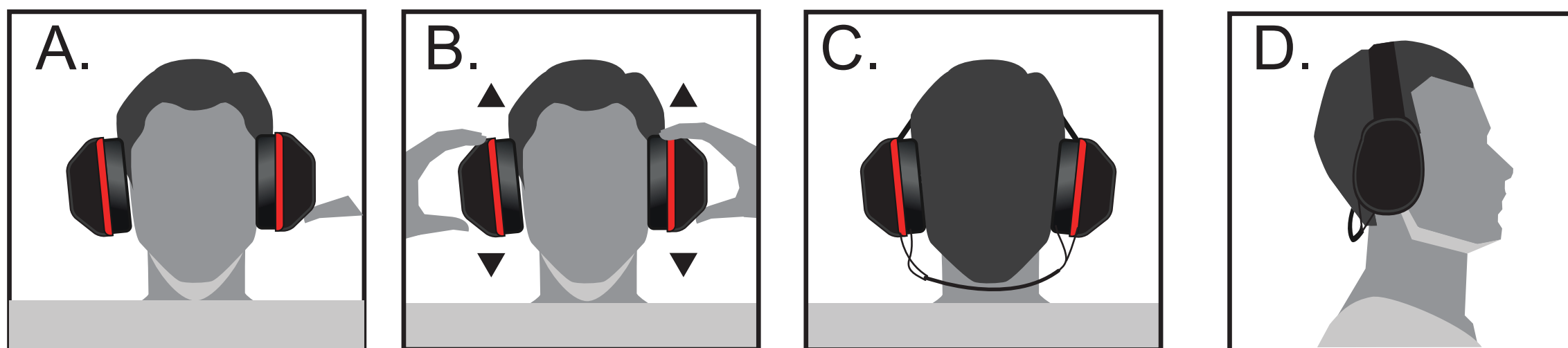

- A. Position the ear cups over your ears so that the cushions fully enclose the ears and seal tightly against the head.
- B. Adjust the height of each ear cup until you have a tight and comfortable fit that exerts even pressure around the ears.
- C. Neckband should be behind the neck.
- D. Lock the strap with the hook on the top of your head and tighten it.