

广州金海纳防护用品有限公司

GUANGZHOU J&Y SAFETY PRODUCTS MANUFACTURER CO., LTD.



HEARING PROTECTION

Choosing the Right Hearing Protection

All Products throughout this section have a Standard Noise Reduction (SNR) rating to help you choose the right hearing protection. First of all, the working environment noise level must be established for you to then calculate which SNR rating you require.

Example:

Working in an environment with a 100dB noise level requires hearing protection of 20dB-25dB to bring the noise level into the safe zone of below 80dB.

Protection Marking Chart

	dBA		
Harmful Range	140		Jet Engine
	130		Riveting Hammer
	120		Propeller Aircraft
	110		Rock Drill
	100		Plate Fabrication Shop
	90		Heavy Vehicle
Upper Action Level	85		Busy Traffic
Lower Action Level	80		Private Car
	70		
	60		Conversation



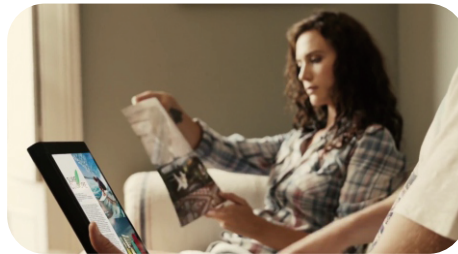

Instruction for Disposable Ear plugs



Hearing Protection by J&Y

We produce premium quality earplugs with raw materials original from Germany. It's sent to the international lab for testing, all passed by one time. It's also passed the main 8 heavy metal test and chemical test.

To test and use the disposable foam earplug in a professional way,

1. ROLL: with clean hands roll the earplug between your thumb and forefinger into a thin crease free cylinder. Keep rolling the plug tighter until it is as thin as you can make it.
2. INSERT: Keep the earplug compressed tightly and use your free hand to reach over your head to lift your ear upward to open the ear canal. Quickly insert the compressed plug deeply in your ear canal.
3. HOLD: Keep your finger at the end of the earplug for 35 seconds until the plug fully expands to fit the whole ear canal.
4. FIT CHECK ask some to confirm the correct fit and check if the plug is fully inserted in the ear canal. Only the tip should be visible and be able to felt. If the plug is not deeply inserted, re-fit per steps.

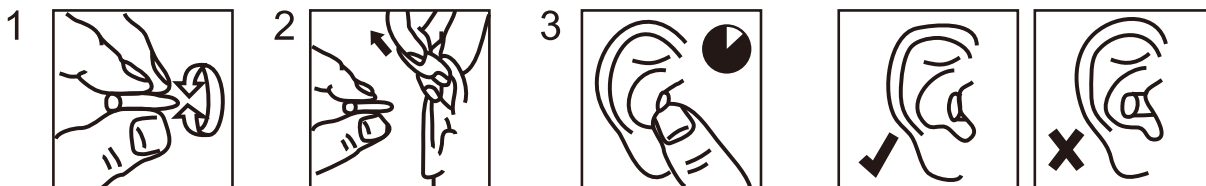

The best rebound time in the ear canal is around 30-40 seconds under human body temperature, neither too fast nor too slow, as it allows the plug fully insert the ear canal. However, Rebound time will vary with the ambient temperature goes too hot or too cold when fitting the earplug.

Instruction for Reusable Ear plugs

Application:

Suitable for sleeping, travelling, swimming, surfing, showering, studying, working and sporting events.

Reach around your head and pull up and back on your outer ear. This straightens out the ear canal, making way for a snug fit.

Hold the stem end of the ear plug and insert it well inside your ear canal.

Make sure you feel it sealing and the fit is comfortable.

To remove, twist earplugs gently to break the seal and remove them slowly.

They should be cleaned often in mild soapy water.

If they become hard, torn or deformed, they should be replaced.

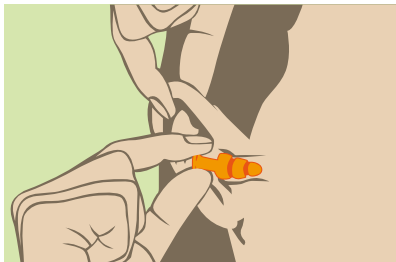

While holding the stem, reach a hand over your head and gently pull top of your ear up and back.

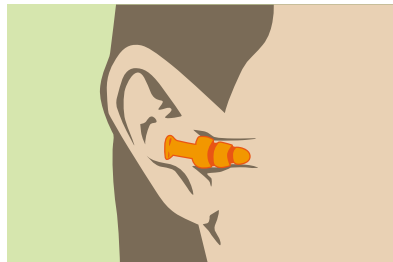

Insert the earplug so all flanges are well inside your ear canal.

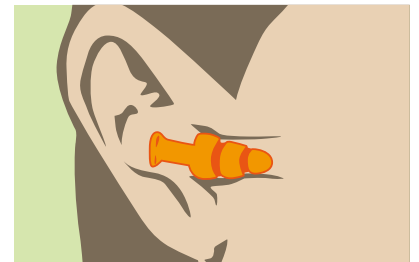

If properly fitted, the tip of the earplug stem may be visible to someone looking at you from the front.

Instruction for Hard Hat Attached Earmuffs

Fitting Instructions

This model of ear muff is to be worn with a hard hat. When worn correctly, the earmuff is fixed into the hard hat's side accessory slots.



A



B



C



D

- A. Push the 25mm earmuff adapter firmly into the accessory slot on the side of the hard hat.
- B. Put the hard hat on and push the earmuffs inwards to engage their active position covering your ears.
- C. Adjust the earmuff up and down for personalised fit.
- D. When not wearing the earmuffs, pull the earmuffs away from the ears, turn 90 degrees and place them in the rest position.

Instruction for Over-The-Head Earmuffs

Fitting Instructions

This model of ear muff is to be worn over the head. When worn correctly, the head band of the earmuff is to rest on top of your head.



A Pull the cups outward and place over your ears so that the cushions fully enclose the ears and seal tightly against the head



B Adjust the height of each cup on both sides while holding the headband down until you have a tight and comfortable fit



C The headband should sit straight on the head

Instruction for Behind-The-Head Earmuffs



A. Put in the ear-muff, ear-muffs should be adjusted until fitted (cover) to both ears.

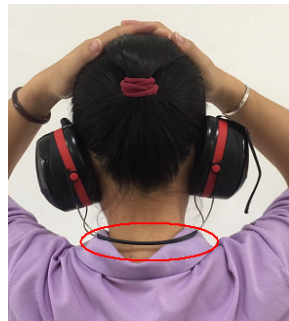

B. Neckband should be behind the neck.



C. Lock the strap with hook on the top of the head and make it tight.



photo like this.